

FOLLOW THESE STEPS TO CORRECT ANY GAP IN THE TREAD:

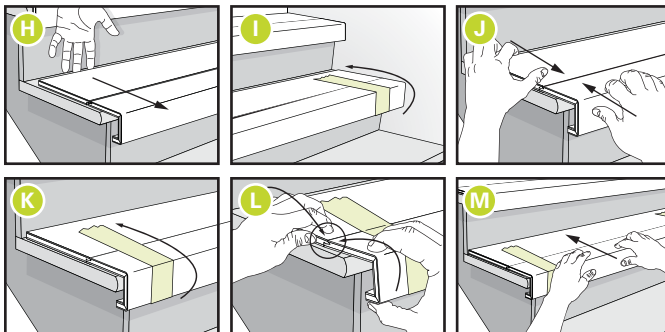

Step 1: Prepare the Staircase

1. Clean the staircase thoroughly, removing all dust and debris.
2. Ensure all wood or concrete stair surfaces are stable, flat, and free of adhesive residue or anything that may prevent bonding.

IMPORTANT: Installing over existing flooring on stairs is not permitted. Any existing flooring must be removed.

Step 2: Measure and Cut the Treads

1. Measure each stair and cut the NovaTreads to size, leaving up to 1/16" on each side (A).

NOTE: Use a sliding or compound miter saw, cutting with the tread face upward to prevent chipping.

2. Dry-fit each tread before applying adhesive. Place the treads on the steps, but **do not remove the tape until you have installed it with adhesive in place!**

CAUTION: If the tread has padding attached, check for secure adhesion. If the padding is loose, use a utility knife to score it 1/2" on both sides of the tape along the underside of the tread. Peel off the padding, leaving the area near the tape intact.

3. Start at the top of the staircase and work your way down to avoid stepping on freshly installed steps.

Step 3: Apply Adhesive to the Step

1. Squeeze a consistent 1/4-inch bead of Molding Adhesive from the front edge to the back of the step. Apply it in a zigzag pattern to maximize coverage and bond strength (B).

Step 4: Apply Adhesive to the Tread

1. Place the tread upside down on the landing or the step above the one you're installing.
2. Apply a 3/8" bead of Molding Adhesive along the upper front edge of the tread, then add another bead along the concave inside of the bullnose section (C).

NOTE: Plan for about one 10 oz. cartridge of adhesive per step.

Step 5: Position the Tread on the Step

1. Align the tread with the front of the step, then slowly rotate it down into position (D).
2. Step on the tread and gently walk on it to press it firmly into place, with a gentle push against the back of the step.

Step 6: Remove the Tape and Check for Gaps

1. Immediately remove the tape from the top of the tread after positioning it (F).
2. Inspect the click-lock mechanism to ensure there are no gaps (G).

NOTE: If a gap is present, follow these steps to correct it:

- Gently slide the tread forward just enough to place your fingers behind it (H).
- If one side of the click-lock is engaged, use an 8" piece of the removed tape to secure the engaged side (I).
- For the side with a gap, use your hand or a flooring pull bar to pull the back of the tread forward while guiding the front with your other hand (J).
- Take another 8" piece of removed tape, wrap it under the front edge of the tread, pull it tightly towards the back, and secure it down (K).
- Slightly tilt the VersaCap up as needed to properly reengage the click system (L).
- Push the entire tread back into position and place a weight on the middle of the VersaCap section to hold it in place (M).

Step 7: Allow Adhesive to Cure

1. Allow the adhesive to cure for 24 hours before any light traffic on the steps.
2. Once the adhesive is fully cured, remove any remaining tape.



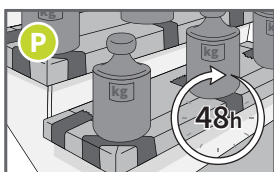
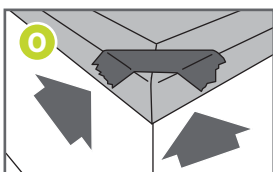
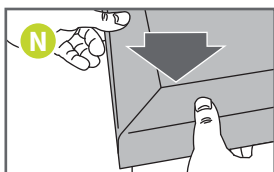
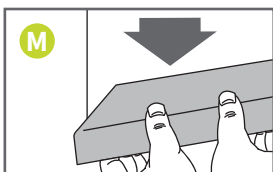
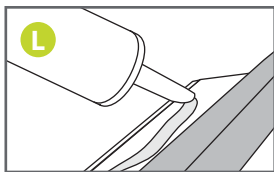
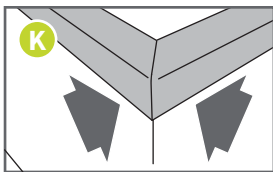
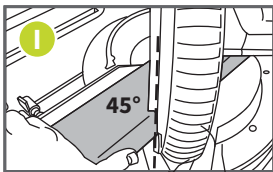
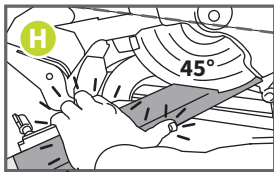
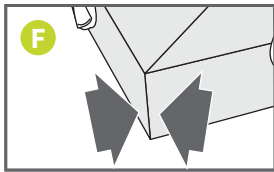
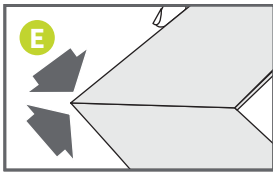
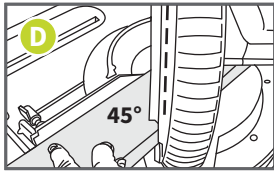
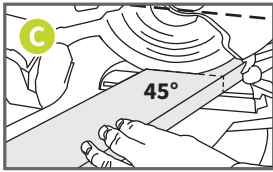
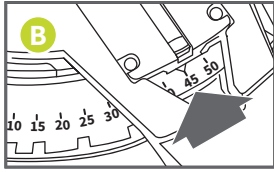
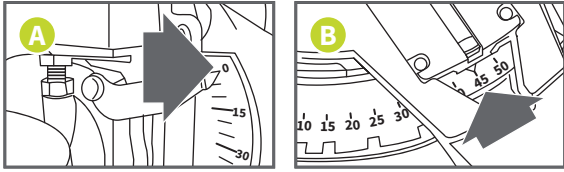

Make sure to use safety goggles and thick gloves while using saw and handling the blade

STEP 1 – Make Test Cuts on Scrap 2x4

IMPORTANT: Make sure the bevel angle is set to ZERO (A).

We highly recommend you do a test cut on 2 scrap pieces of 2x4 to make sure your cuts line up. Set the miter angle to 45 degrees for the first cut (B). Cut the 2x4 (C).

Then change angle of miter cut to 45 degrees in the other direction (D). Cut the other piece of 2x4.

Line up ends of the 2x4s to form a corner (E). Check the pieces to see if they line up correctly with **no gap** on the top or front view (F).

STEP 2 – Cut Your NovaCap

IMPORTANT: Use a scrap 2x4 piece to set NovaCap on while you make the cuts (G). This will keep them level as you cut.

Set the miter angle to 45 degrees. Cut the NovaCap (H).

REMEMINDER: Always wear safety goggles when using the saw

IMPORTANT: Hold the NovaCap extremely tight, otherwise it will pull in the direction of the blade and your cut will be off

Change miter angle to 45 degrees in the other direction (I). Cut the other piece that you are using for the Return. Again, **make sure you hold the NovaCap extremely tight. Don't let it move while you make the cut.**

Check the Cap & Return to see if they line up correctly with **no gap** on the top or front view (J).

STEP 3 – Applying Cap & Return to the Stairs

IMPORTANT: The NovaCap does not come with an underlayment. Apply enough adhesive to the broad flat area to make the Caps & Returns level with the floor plank.

After wiping the Cap & Return clean from debris, test the fit on your stairway. Make sure there is no gap between them (K).

After you test the fit, run thick lines of **Graphite adhesive** (or comparable PUR adhesive) along the inside corner and along the broad flat surface of the NovaCap (L).

Put the Cap in place, pressing down firmly to make sure it is in contact with the stair (M). Make sure the edge is square.

Clean up any excess adhesive with a damp rag.

IMPORTANT: Make sure the underlayment is firmly and completely attached to the floor plank. If it is not, either remove it or reattach it with PUR adhesive.

Next, take the plank and Return that go with the NovaCap you just fixed on the Stair. Turn them over and apply a generous amount of adhesive to them. Apply glue to the inside corner of the return and then apply adhesive to the broad flat area.

Next, place the plank and Return in place (N).

Clean up any excess adhesive with a damp rag before applying the painters tape.

While pressing both ends firmly together, stretch a piece of painter's tape tightly across the corner edge to keep the moldings from separating while the adhesive cures (O).

Place a heavy weight across the seams (P).

Let the adhesive cure for 48 hours before heavy traffic. Once dry, you can remove painter's tape from stairs.

When we machine the planks we change the symmetry of tension and some bowing is to be expected. Here is how you install a slightly bowed NovaCap:

- After you cut your planks and NovaCaps to size, dry fit them to see which caps are bowing. You may see a slight 1 to 2 mm gap either towards the ends of the plank or towards the middle caused by the bowing.
- Glue your NovaCap in place on the step. Then apply glue to the back of the plank. We also advise to put a thin swipe of construction glue into the click system of the floor plank.
- Line up the plank to the NovaCap so that both ends meet.
- Start at one end and snap the plank into place by lining it up with the NovaCaps groove and lowering it down.
- Take a strip of painter's tape and start towards the very top of the flooring plank and end under the lip of the NovaCap, or even on the stair riser below the cap, pulling tightly so that the NovaCap and plank are held snug in place by the tape.
- Work your way down to the other end, pressing firmly and using your body weight to push the flooring groove into the NovaCap until it snaps into place.
- Then add strips of painter's tape to the other end and to the center of the tread to hold the NovaCap in place until the glue dries. Apply weights.